

HAAKSE INSCHROEFKOPPELING RACCORDS FILETÉS COUDÉS

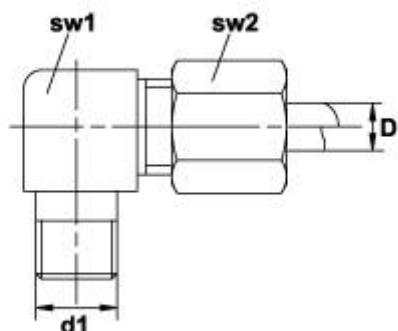

Artikelnummer / Référence	D	d1	sw1	sw2
CK.WE.04M06X100	4	6 x 1	9	10
CK*WE.04M06X100	4	6 x 1 inox	9	10
CK.WE.04M06X75	4	6 x 0,75	12	12
CK.WE.04M08X100	4	8 x 1	9	10
CK*WE.04M08X100	4	8 x 1 inox	9	10
CK.WE.04M08X125	4	8 x 1,25	9	10
CK.WE.04M10X100	4	10 x 1	9	10
CK*WE.04M10X100	4	10 x 1 inox	9	10
CK.WE.04R02	4	R 1/8 BSP	9	10
CK*WE.04R02	4	R 1/8 BSP inox	9	10
CK.WE.05M06X100	5	6 x 1	11	12
CK.WE.05M08X100	5	8 x 1	11	12
CK.WE.05M10X100	5	10 x 1	11	12
CK.WE.05R02	5	R 1/8 BSP	11	12
CK.WE.06LLM06X1	6	6 x 1	11	12
CK*WE.06LLM08X1	6	6 x 1 INOX	11	12
CK.WE.06LLM08X1	6	8 x 1	11	12
CK.WE.06LLM08X125	6	8 x 1.25	11	12
CK*WE.06LLM08X1	6	8 x 1 INOX	11	12
CK.WE.06LLM10X1	6	10 x 1	11	12
CK*WE.06LLM10X1	6	10 x 1 INOX	11	12
CK.WE.06LLR02	6	R 1/8 BSP	11	12

Artikelnummer / Référence	D	d1	sw1	Sw2
CK.WE.06LL02NPT	6	1/8 NPT	11	12
CK*WE.06LL02NPT	6	1/8 NPT inox	11	12
CK*WE.06LLR02PTF	6	1/8 " PTF inox	11	12
CK.WE.06SAE04	6	¼-28 SAE	11	12
CK*WE.06SAE04	6	¼-28 SAE inox	11	12
CK.WE.06UNF04	6	¼-28	11	12
CK*WE.06UNF04	6	¼-28	11	12
CK*WE.06LLR02	6	R 1/8 BSP inox	11	12
CK*WE.06LR04	6	CK*WE.06LR04 rvs	12	14
CK.WE.06LR04	6	R 1/4 BSP	12	14
CK*WE.08LLM6X1	8	M 6 x 1 INOX	12	14
CK*WE.08LLM8X1	8	M 8 x 1 INOX	12	14
CK.WE.08LLM10X1	8	M 10 x 1	12	14
CK*WE.08LLM10X1	8	M 10 x 1 INOX	12	14
CK.WE.08LLR02	8	R 1/8 BSP	12	14
CK*WE.08LLR02	8	R 1/8 BSP INOX	12	14

RECHTE INSCHROEFKOPPELING RACCORDS À VIS DROIT UNION MÂLE

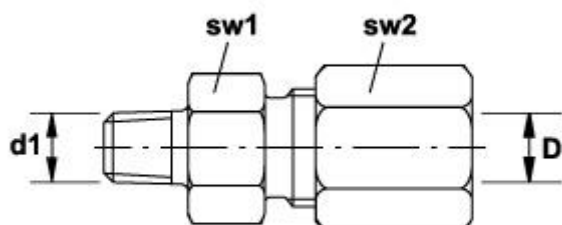

Artikelnummer / Référence	D	d1	sw1	sw2
CK.GE.04M06X100	4	M 6 x 1	11	10
CK*GE.04M06X100	4	M 6 x 1 INOX	11	10
CK.GE.04M06X075	4	M 6 x 0,75	11	10
CK.GE.04M08X100	4	M 8 x 1	11	10
CK*GE.04M08X100	4	M 8 x 1 INOX	11	10
CK.GE.04M08X125	4	M 8 x 1,25	11	10
CK.GE.04M10X100	4	M 10 x 1	11	10
CK*GE.04M10X100	4	M 10 x 1 INOX	11	10
CK.GE.04R02	4	R 1/8 BSP	11	10
CK*GE.04R02	4	R 1/8 BSP INOX	11	10
CK.GE.04BSF04	4	¼ BSF	11	10
CK.GE.04LL02NPT	4	1/8 NPT	11	10
CK.GE.05M06X100	5	M 6 x 1	11	12
CK.GE.05M08X100	5	M 8 x 1	11	12
CK.GE.05M10X100	5	M 10 x 1	11	12
CK.GE.05LLR02	5	R 1/8 BSP	11	12
CK.GE.06LLM06X1	6	M 6 x 1	11	12
CK.GE.06LLM06X0.75	6	M 6 x 0,75	12	12
CK*GE.06LLM06X1	6	M 6 x 1 INOX	11	12
CK.GE.06LLM08X1	6	M 8 x 1	11	12
CK*GE.06LLM08X1	6	M 8 x 1 INOX	11	12

CK.GE.06LLM08X1.25	6	M 8 x 1.25	11	12
CK*GE.06LLM08X1.25	6	M 8 x 1.25 INOX	11	12
CK.GE.06LLM10X1	6	M 10 x 1	11	12
CK*GE.06LLM10X1	6	M 10 x 1 INOX	11	12
CK.GE.06LLR02	6	R 1/8 BSP	11	12
CK*GE.06LLR02	6	R 1/8 INOX	11	12
CK.GE.06LL02NPT	6	1/8-27 NPT	11	12
CK*GE.06LL02NPT	6	1/8-27 NPT INOX	11	12
CK*GE.06LLR02PTF	6	1/8 PTF	11	12
CK.GE.06SAE04	6	¼ - 28 SAE	11	12
CK*GE.06SAE04	6	¼ - 28 SAE	11	12
CK.GE.06UNF04	6	UNF ¼ 28	11	12
CK.GE.06L04NPT	6	1/4-18 NPT	12	14
CK*GE.06LLR04UNF	6	¼ UNF 28 INOX	11	12
CK*GE.06LPT02	6	1/8 PT INOX	12	14
CK.GE.06LR04	6	R 1/4 BSP	12	14
CK*GE.06LR04	6	R 1/4 BSP INOX	12	14
CK.GE.06LR04NPT	6	R ¼ NPT	12	14
CK.GE.08LLM06X1	8	M 6	14	14
CK*GE.08LLM06X1	8	M 6 INOX	14	14
CK.GE.08LLM08X1	8	M 8 x 1	14	14
CK*GE.08LLM08X1	8	M 8 x 1 INOX	14	14
CK.GE.08LLM10X1	8	M 10 x 1	14	14
CK*GE.08LLM10X1	8	M 10 x 1 INOX	14	14
CK.GE.08LLR02	8	R 1/8 BSP	14	14
CK*GE.08LLR02	8	R 1/8 BSP	14	14
CK.GE.08LLR02NPT	8	1/8 NPT	14	14
CK.GE.08LLR04	8	R ¼ BSP	14	14

RECHTE KOPPELING RACCORDS À VIS DROIT CONNECTEUR UNION DOUBLE

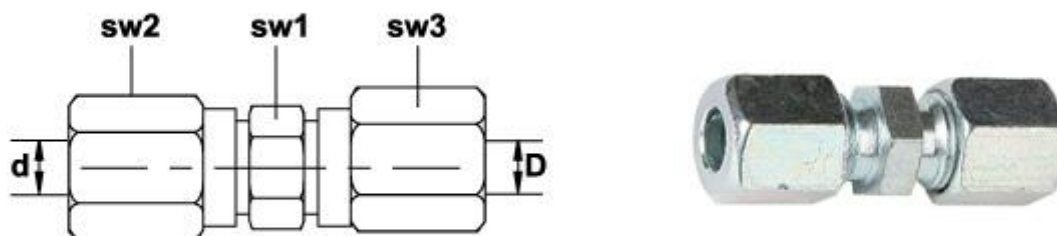

Artikelnummer / Référence	d	D	sw1	sw2	sw3
CK.G.04LL	4	4	9	10	10
CK*G.04LL	4	4	9	10	10
CK.RV.G-06-04	4	6	9	10	12
CK.RV.G-06-05	5	6	11	12	12
CK.G.05LL	5	5	11	12	12
CK*G.05LL	5	5	11	12	12
CK.G.06LL	6	6	11	12	12
CK*G.06LL	6	6	11	12	12
CK.RV.G.08-06	6	8	12	12	14
CK.RV.G.10-06	6	10	17	14	19
CK.G.08LL	8	8	12	14	14
CK.G.08	8	8	14	17	17
CK*G.08	8	8	14	17	17
CK.G.10	10	10	17	19	19
CK*G.10	10	10	17	19	19

T-KOPPELINGEN RACCORDS À VIS EN T

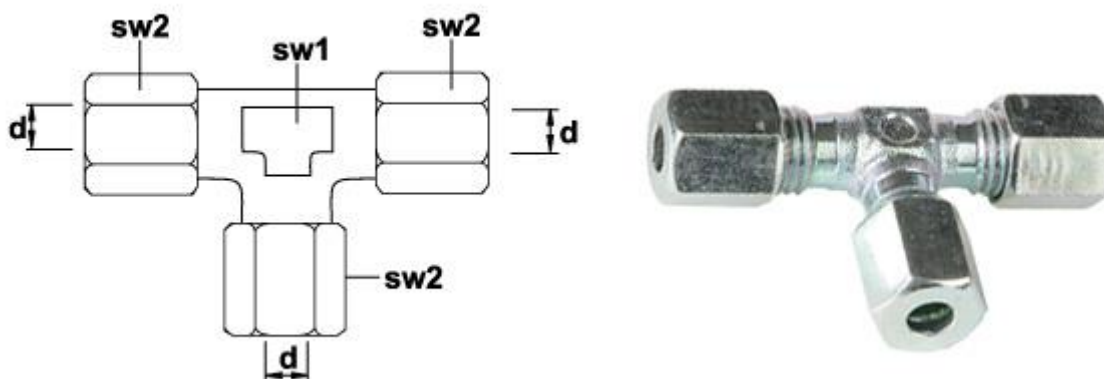

Artikelnummer / Référence	d	sw1	sw2
CK.T.04LL	4	9	10
CK*T.04LL INOX	4	9	10
CK.T.05LL	6	11	12
CK*T.05LL INOX	6	11	12
CK*T.06LL INOX	6	11	12
CK.T.06LL	6	11	12
CK.T.06L	6	12	14
CK.T.08LL	8	12	14
CK*T.08LL INOX	8	12	14

OVERSTEEKMOER (DIN 2353) ÉCROUS DE SERTISSAGE

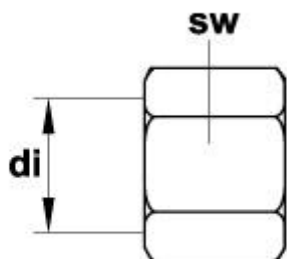

Artikelnummer / Référence	di	sw
CK.OSM.04LL	4	10
CK*OSM.04LL INOX	4	10
CK.OSM.06LL	6	12
CK*OSM.06LL INOX	6	12
CK.OSM.08LL	8	14
CK*OSM.08LL INOX	8	14
CK.OSM.10L	10	19
CK*OSM.10L INOX	10	19

SNIJRING DIN 3861 BAGUES DE SERTISSAGE

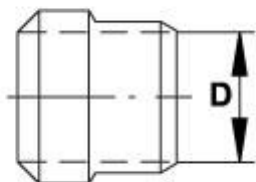

Artikelnummer / Référence	D
CK.SR.04LL	4
CK*SR.04LL INOX	4
CK.SR.06LL	6
CK*SR.06LL INOX	6
CK.SR.08LL	8
CK*SR.08LL INOX	8
CK.SR.10L	10
CK*SR.10LL INOX	10

STEEKOPPELING HAAKS RACCORDS INSTANTANÉS COUDÉS

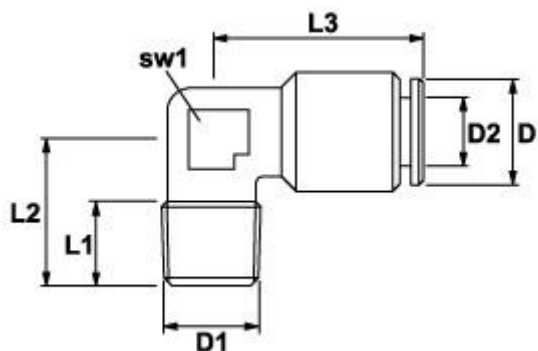

Artikelnummer / Référence	D	D1	D2	sw1	L1	L2	L3
CK.SK.WE-04M06	9	M6 x 1	4	10	7,5	16,5	20
CK.SK.WE-04M06X075	9	M6 x 0,75	4	10	7,5	16,5	20
CK.SK.WE-04M08X100	9	M8 x 1	4	10	8	16.5	20
CK.SK.WE-04M10X100	9	M10 x 1	4	10	8	17	20
CK.SK.WE-04M10X1.5-H	9	M10 x 1,5	4	10	8	17	20
CK.SK.WE-04R02	9	R 1/8 BSP	4	10	8	15	20
CK.SK.WE-04R02NPT	9	1/8 NPT	4	10	8	17	20
CK.SK.WE-04R05-24	9	5/16 " 24 UNF	4	10	8	17	20
CK.SK.WE-06M06X100	12	M6 x 1	6	10	7,5	16,5	21
CK.SK.WE-06M06X075-H	12	M6 x 0,75	6	10	7,5	16,5	21
CK.SK.WE-06M08X100	12	M8 x 1	6	10	8	16.5	21
CK.SK.WE-06M08X125-H	12	M8 x 1,25	6	10	8	16.5	21
CK.SK.WE-06M10X100	12	M10 x 1	6	10	8	17	21
CK.SK.WE-06M10X1.5-H	12	M10 x 1,5	6	10	8	17	21
CK.SK.WE-06R02	12	R 1/8 BSP	6	10	8	15	21
CK.SK.WE-06R02NPT	12	1/8 NPT	6	10	8	16	21
CK.SK.WE-06R04UNF	12	1/4 - 28 UNF	6	10	7	15	21
CK.SK.WE-06R05-24	12	5/16" UNF	6	10	7	15	21

STEEKOPPELING HAAKS DRAAIBAAR RACCORDS INSTANTANÉS COUDÉS TOURNABLE

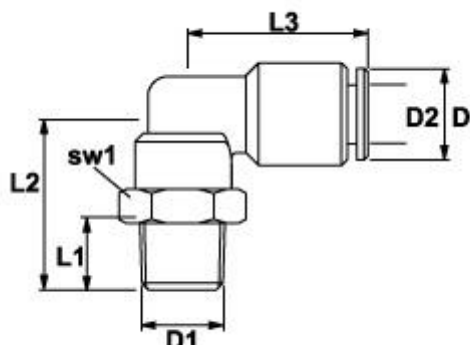

Artikelnummer / Référence	D	D1	D2	sw1	L1	L2	L3
CK.SK.WE-DR-04M06X100	9	M6 x 1	4	13	8	20,5	20
CK.SK.WE-DR-04M08X100	9	M8 x 1	4	13	8	20,5	20
CK.SK.WE-DR04M08X125	9	M8 x 1,25	4	13	8	20,5	20
CK.SK.WE-DR-04M10X100	9	M10 x 1	4	13	8	20,5	20
CK.SK.WE-DR-04M10X150	9	M10X1	4	13	8	20,5	20
CK.SK.WE-DR-04R02	9	R 1/8 BSP	4	13	7,5	20	20
CK.SK.WE-DR-04R02NPT	9	1/8 NPT	4	13	7	21	
CK.SK.WE-DR-04R02UNF	9	1/4 – 28 UNF	4	13	7	21	
CK.SK.WE-DR-06M06X100	12	M6 x 1	6	13	8	20,5	21,5
CK.SK.WE-DR-06M08X100	12	M8 x 1	6	13	8	20,5	21,5
CK.SK.WE-DR-06M08X125	12	M8 x 1	6	13	8	20,5	21,5
CK.SK.WE-DR-06M10X100	12	M10 x 1	6	13	8	21,5	21,5
CK.SK.WE-DR-06M10X150	12	M10 x 1,5	6	13	8	21,5	21,5
CK.SK.WE-DR-06R02	12	R 1/8 BSP	6	13	7,5	20,5	21,5
CK.SK.WE-DR-06R02NPT	12	1/8 NPT	6	13	8,5	21,5	
CK.SK.WE-DR-06R02UNF	12	1/4 – 28 UNF	6	13	7	21	

Matériau: laiton nickel

Pression de service 80 bar

ADAPTER 45° RACCORD COUDE 45°

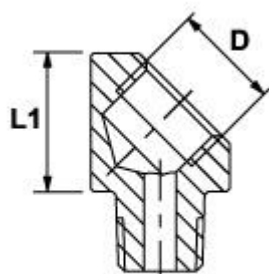
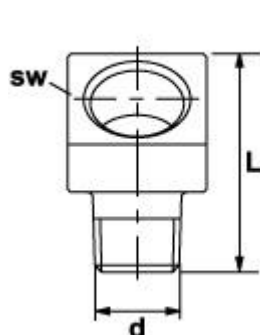

Art. Nr./ Référence	D	d	sw	L	L1
CK.TS.45-M6X1K-M8X1K	M 6x1	M 8x1	13	23	13
CK.TS.45-M8X1-M8X1	M 8x1	M 8 x 1	13	23	13
CK.TS.45-M8X1-M8	M 8x1	M 8x1,25	13	23	13
CK.TS.45-M8X1-M10X1	M 8x1	M 10x1	13	23	13
CK.TS.45-M10X1-M10X1	M 10x1	M 10 x 1	13	23	13
CK*TS.45-M10X1-M10X1	M 10x1 INOX	M 10 x 1 INOX	13	23	13
CK.TS.45-R02-M6X1	R 1/8 BSP	M 6x1	13	23	13
CK.TS.45-R02-R02	R 1/8 BSP	R 1/8 BSP	13	23	13
CK*TS.45-R02-R02	R 1/8 BSP RVS	R 1/8 BSP	13	23	13
CK.TS.45-R02NPT-R02NPT	1/8 NPT	1/8 NPT	13	23	13
CK.TS.45-R04R04	R 1/4 BSP	R 1/4 BSP	13	23	13

ADAPTER 90° RACCORD COUDÉ 90°

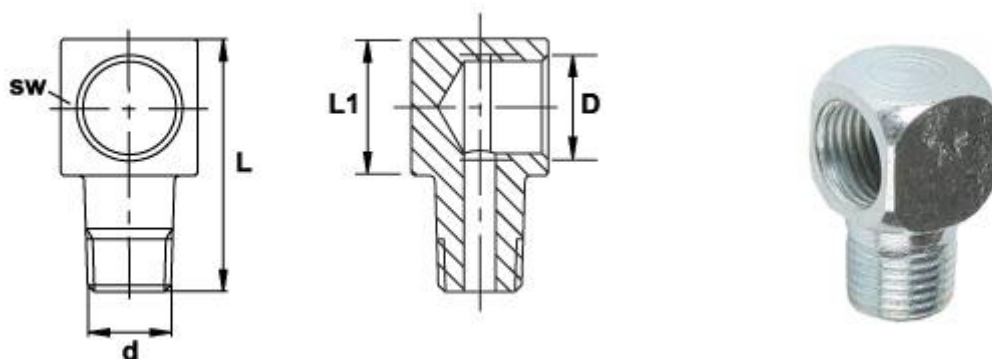

Artikelnummer / Référence	D	d	sw	L	L1
CK.TS.90-M6X1-M6X1	M 6x1	M 6x1	12	23	13
CK.TS.90-M8X1-M6X1	M 8x1	M 6x1	12	23	13
CK.TS.90-M8X1-M8X1	M 8x1	M 8x1	12	23	13
CK.TS.90-M8-M8	M 8x1,25	M 8x1,25	12	23	13
CK.TS.90-M8X1-M10X1	M 8x1	M 10x1	12	23	13
CK.TS.90-M10X1-M6X1	M 6x1	M 10x1	12	23	13
CK*TS.90-M10X1-M6X1	M 6x1 INOX	M 10x1 INOX	12	23	13
CK.TS.90-M10X1-M8X1	M 10x1	M 8x1	13	23	13
CK*TS.90-M10X1-M8X1	M 10x1 INOX	M 8x1 INOX	12	23	13
CK.TS.90-M10X1-M10X1	M 10x1	M 10x1	13	23	13
CK*TS.90-M10X1-M10X1	M 10x1 INOX	M 10x1 INOX	13	23	13
CK.TS.90-M10X1-M10X1.5	M 10x1	M 10x1,5	13	23	13
CK.TS.90-R02-R02	R 1/8 - BSP	R 1/8 BSP	13	23	13
CK*TS.90-R02-R02	R 1/8 - BSP	R 1/8 BSP	13	23	13
CK.TS.90-R02-R04UNF	R 1/8 - BSP	¼-28 UNF	13	23	13
CK.TS.90-R02NPT-R02NPT	1/8 NPT	1/8 NPT	9/16"	23	13
CK.TS.90-R02NPT-M6x1	1/8 NPT	M 6x1	9/16"	23	13
CK.TS.90-R02NPT-R04UNF	1/8 NPT	¼-28 UNF	13	23	13
CK.TS.90-M8X1-R02	M 8x1	R 1/8 BSP	12	23	13
CK.TS.90-R04-R04	R 1/4 BSP	R 1/4 BSP	17	33	18

OVERSTEEKVIJS STAAL RACCORDS À BAGUE À SERTIR POUR MONOCÔNE DOUBLE

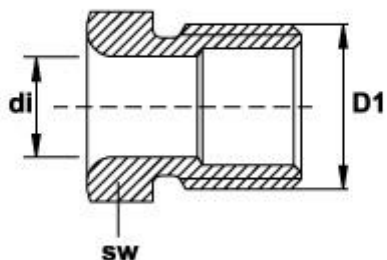

Artikelnummer / Référence	D1	di	sw	L
LK.OSV.ST-04	M 8 x 1	4	8	12
LK.OSV.ST-06	M 10 x 1	6	10	14
LK.OSV.ST-10	M 16 x 1,5	10	17	17

KNELRING MESSING MONOCÔNE DOUBLE

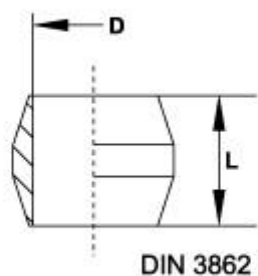

Artikelnummer / Référence	D	L
LK.KR.ME-04	4	5,5
LK*KR.ME-04 INOX	4	5,5
LK.KR.ME-06	6	7

SCHROEFHULS MANCHETTE

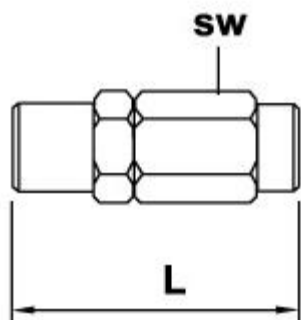

Schroefhuls voor hogedrukleiding Ø 4,1 x 8,75
Manchette à vis pour tuyau haute pression Ø 4,1 x 8,75

Artikelnummer / Référence	L	sw
LK.SH.HAF-04	28	12
LK*SH.HAF-04 INOX	28	12

Schroefhuls voor hogedrukleiding Ø 6,35 x 11,3
Manchette à vis pour tuyau haute pression Ø 6,35 x 11,3

Artikelnummer / Référence	L	sw
LK.SH.HAF-06,3	35,8	17
LK*SH.HAF-06,3 INOX	35,8	17

VERLENGSTUK BUITENDR.-BINNENDR RACCORDS À FILETAGE CONIQUE / ALLONGEMENT

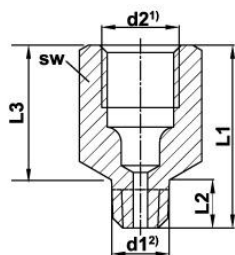

Artikelnummer / Référence	d1	d2	L1	L2	L3	sw	tuyau Ø
FI.526.M5-M5-18-5-M	M 5	M 5	18,5				
FI.526.M6-M6-23	M 6 x 1	M 6 x 1	20	7,5	12,5	9	
FI*526.M6-M6-30 INOX	M 6 x 1	M 6 x 1	30	10	20		
FI.526.M6-M6-57	M 6 x 1	M 6 x 1	57,5	7,5	50	9	
FI.526.M6-M8X1-18	M 6 x 1	M 8 x 1	18	8	10	11	4
FI.526.M6-M10x1-23	M 6 x 1	M 10 x 1	23	10	13	11	6
FI*526.M6-M10x1-18	M 6 x 1	M 10 x 1	18				
FI.526.M6-R02-23	M 6 x 1	R 1/8 BSP	23	10	13	11	
FI*526.M6-R02-23 INOX	M 6 x 1	R 1/8 BSP	23	10	13	11	
FI.526.M8X1-M8X1-18	M 8 x 1	M 8 x 1	18	8	10	11	4
FI*526.M8X1-M8X1-17 INOX	M 8 x 1	M 8 x 1	17				
FI.526.M8X1.25-20	M 8 x 1,25	M 8 x 1,25	20	7	13	11	
FI.526.M8X1-M8X1-32	M 8 x 1	M 8 x 1	32	22	10	11	4
FI.526.M8X1.25-32	M 8 x 1,25	M 8 x 1,25	32	22	10	11	
FI.526M8X1-M8X1-62,5	M 8 x 1	M 8 x 1	62,5	52,5	10	11	4
FI*526.M8X1-M10X1-18 INOX	M 8 x 1	M 10 x 1	18	8	10		
FI.526.M8X1-M10X1-23	M 8 x 1	M 10 x 1	23	12	11	13	6
FI.526.M8X1-R02-23	M 8 x 1	R 1/8 BSP	23	12	11	13	
FI*526.M8X1-R02-23 INOX	M 8 x 1	R 1/8 BSP	23	12	11	13	
FI.526.M8X1-R04-22	M 8 x 1	R 1/4 BSP	22	8	14	17	
FI.526.M10X1-M8X1-18	M 10 x 1	M 8 x 1	18	8	10	11	4
FI*526.M10X1-M8X1-18	M 10 x 1	M 8 x 1	18	8	10	11	4
FI.526.M10X1-M10X1-18	M 10 x 1	M 10 x 1	18	7	11	13	6
FI*526.M10X1-M10X1-18	M 10 x 1	M 10 x 1	18	8	10		
FI.526.M10X1-M10X1-23	M 10 x 1	M 10 x 1	23	12	11	13	6
FI.526M10X1.5-M10X1-23	M 10 x 1,5	M 10 x 1	23	12	11	13	

Artikelnummer / Référence	d1	d2	L1	L2	L3	sw	tuyau Ø
FI*526.M10X1-M10X1-23 INOX	M 10 x 1	M 10 x 1	23	12	11	13	6
FI.526.M10X1-M10X1-35	M 10 x 1	M 10 x 1	35	24	11	13	6
FI*526. M10X1-M10X1-35 INOX	M 10 x 1	M 10 x 1	35	24	11	13	6
FI.526.M10X1-M10X1-40	M 10 x 1	M 10 x 1	40	29	11	13	6
FI.526.M10X1-M10X1-50	M 10 x 1	M 10 x 1	50	39	11	13	6
FI*526.M10X1-M10X1-50 INOX	M 10 x 1	M 10 x 1	50	39	11	13	6
FI.526.M10-R02-18	M 10 x 1	R 1/8 BSP	18	7	11	13	
FI.526.M10-R04-22	M 10 x 1	R 1/4 BSP	20	9	11	17	
FI.526.R02-M10X1-18	R 1/8 BSP	M 10 x 1	18	7	11	13	6
FI.526.R02-R02-18	R 1/8 BSP	R 1/8 BSP	18	7	11	13	
FI*526.R02-R02-18 INOX	R 1/8 BSP	R 1/8 BSP	18	7	11	13	
FI.526.R02-M8X1-18	R 1/8 BSP	M8 x 1	18	7	11	13	4
FI.526.R02-R02-23	R 1/8 BSP	R 1/8 BSP	23	12	11	13	
FI*526.R02-R02-23 INOX	R 1/8 BSP	R 1/8 BSP	23	12	11	13	
FI.526.R02-R02-30	R 1/8 BSP	R 1/8 BSP	30	18	12	13	
FI.526.R02-R02-35	R 1/8 BSP	R 1/8 BSP	35	23	12	13	
FI*526.R02-R02-35 INOX	R 1/8 BSP	R 1/8 BSP	35	23	12	13	
FI.526.R02-R02-41	R 1/8 BSP	R 1/8 BSP	41	29	12	13	
FI.526.R02-R02-45	R 1/8 BSP	R 1/8 BSP	45	33	12	13	
FI.526.R02-R02-50	R 1/8 BSP	R 1/8 BSP	50	38	12	13	
FI*526.R02-R02-50 INOX	R 1/8 BSP	R 1/8 BSP	50	38	12	13	
FI.526.R02-R04-22	R 1/8 BSP	R 1/4 BSP	22	8	14	17	
FI.526-R04-M10X1-20	R 1/4 BSP	M 10 x 1	20	9	11	17	6
FI.526-R04-R02-20	R 1/4 BSP	R 1/8 BSP	20	9	11	17	6
FI.526-R04UNF-R02NPT-23	1/4-28 UNF	1/8 NPT	23	9	14	1/2"	
FI.526.R04-R06-27	R 1/4 BSP	R 3/8 BSP	27	11	16	22	
FI.526.R04-R04-25	R 1/4 BSP	R 1/4 BSP	25	17	8	17	
FI.526.R04-R04-50	R 1/4 BSP	R 1/4 BSP	50	36	14	17	
FI.526.R04-R04-65	R 1/4 BSP	R 1/4 BSP	65	51	10	17	
FI.526.R04-R04-85	R 1/4 BSP	R 1/4 BSP	85	71	14	17	
FI.526.R04-R04-104	R 1/4 BSP	R 1/4 BSP	104	90	14	17	
FI.526.R02NPT-MF-20	1/8 NPT	1/8 NPT	20	9	11	1/2	
FI.526.R02NPT-MF-30	1/8 NPT	1/8 NPT	30	18	12	1/2	
FI.526.R02NPT-MF-50	1/8 NPT	1/8 NPT	48	36	12	9/16	
FI.526.R04UNF-R02-23	1/4-28 UNF	1/8 BSP	23	12	11	1/2	

LEIDING PA ZWART TUYAU PA NOIR



DIN 73378

Artikelnummer Référence	Omschrijving Description	da	s	di	Lengte Longueur
LPA.S.6-3HSW	6 x 1,5 *	6	1,5	3,0	100
LPA.HSW.06-03	6 x 1,5 (leeg / vide)	6	1,5	3,0	50

bedrijfsdruk: ca. 89 bar bij 23°C / pression de service: ca.89 bar à 23°C

* met vloeibaar vet gevuld / rempli avec graisse molle

PUSH-IN KOPPELING RECHT RACCORDS INSTANTANÉS DROIT

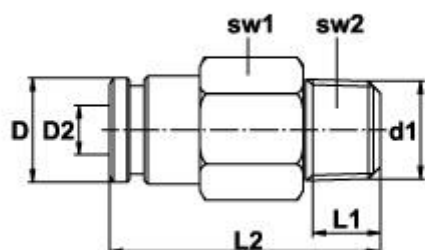

bedrijfsdruk: ca. 80 bar / pression de service: ca.80 bar

Artikelnummer / Référence	D	D1	D2	sw1	sw2	L1	L2
CK.SK.GE.04M06X075	9	6 x 0,75	4	10	3	7,5	18,5
CK.SK.GE.04M06x1	9	6 x 1	4	10	3	7,5	18,5
CK.SK.GE.04M08X1	9	8 x 1	4	10	2,5	8	23
CK.SK.GE.04M10X1	9	10 x 1	4	10	3	8	20
CK.SK.GE.04R02	9	1/8 BSP	4	11	3	8	20
CK.SK.GE.04R02NPT	9	1/8 NPT	4	11		8	20
CK.SK.GE.04R04UNF	9	1/4 – 28 UNF	4	11		8	20
CK.SK.GE.04R05-24	9	5/16 UNF 24	4	11		8	20
CK.SK.GE.06M06X100	12	6 x 1	6	12	3	7,5	21,5
CK.SK.GE.06M08X1	12	8 x 1	6	12	2,5	8	25,5
CK.SK.GE.06M10X1	12	10 x 1	6	12	4	8	25,5
CK.SK.GE.06R02	12	1/8 BSP	6	12	4	8	22
CK.SK.GE.06R02NPT	12	1/8 NPT	6	12		8,5	21,5
CK.SK.GE.06R04	12	1/4 BSP	6	12			
CK.SK.GE.06R04UNF	12	1/4 – 28 UNF	6	12		6	23,5

BANJOKOPPELING RACCORD ORIENTABLE

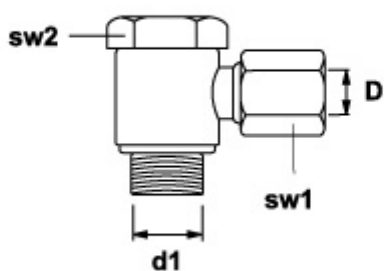

Artikelnummer / Référence	D	D1	sw1	sw2
CK.SWVE.4LLM10	4	10 X 1	12	14
CK.SWVE.6LLM10	6	10 X 1	12	14
CK.SWVE.6LLR02	6	R 1/8	12	14
CK.SWVE.4LLM8X1	4	8 X 1	8	12
CK.SWVE.4LLR02	4	R 1/8	10	14

F-DOORN

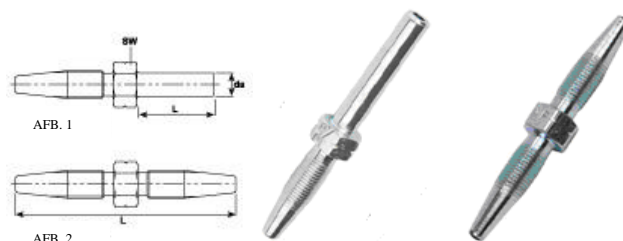

Voor hogedrukleiding 840 bar Ø 4,1 x 8,75

Artikelnummer / Référence	da	L	sw	AFB.
LK.FD.D4-180-20	4	20	10	1
LF.FD.41255642	6	20	10	1
LK*FD.41255642 inox**	6	30	10	1
LK.FD.41255642-B	6	24	10	1
LK.FD.4,1-8,75-6-30	6	30	10	1
LK.FD.2X41255642	6	21,5	10	2
LK.FD-8R-30.8,6-4	8	30	10	1

Voor hogedrukleiding 840 bar Ø 6,35 x 11,3

Artikelnummer / Référence	da	L	sw	AFB.
LK.FD-6,3x11,3-6-180	6	22	12	1
LK*FD-6,3x11,3-6-180 inox**	6	20	12	1
LK.FD.41263241	8	22	12	1
LK*FD.41263241 inox**	8	22	12	1
LK.FD-10R-30.11,3-6	10	30	12	1
LK*FD.6,3X11,3-10-18 inox**	10	30	12	1

** inox 1.4401 / 316 /V4A

PIJPSTUK 90° LEIDING HOGE DRUK EMBOUT 90° TUYAU HAUTE PRESSION



Voor hogedrukleiding 840 bar Ø 4,1 x 8,75

Artikelnummer / Référence	da	h	L	sw
LK.FD.D4-90-30	4	14	30	10
LF.FD.D6-90-21	6	13	21	10
LF.FD.D6-90-38	6	28	37	10
LK*FD.4.1X8.75.90° inox**	6	28	37	10
LK.FD.D6-90-53	6	28	53	10

Voor hogedrukleiding 840 bar Ø 6,35 x 11,3

Artikelnummer / Référence	da	h	L	sw
LF.FD.D6,3X11,3-6-90	6	22	45	12
LF*FD.D6,3X11,3-6-90 inox**	6	22	45	12
LF.FD.D6,3X11,3-8-90	8	23	36	12
LF*FD.D6,3X11,3-8-90 inox**	8	23	36	12
LF.FD.D6,3X11,3-10-90	10	23	36	12
L*.FD.D6,3X11,3-10-90 inox**	10	23	36	12

** inox 1.4401 / 316 / V4A

PIJPSTUK 45° LEIDING HOGE DRUK EMBOUT 45° TUYAU HAUTE PRESSION

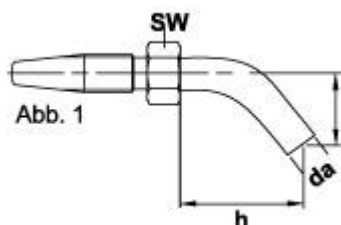

Voor hogedrukleiding 840 bar Ø 4,1 x 8,75

Artikelnummer / Référence	da	h	L	sw
LF.FD.D6-45	6	24	15	10
LF*FD.4,1X8.75-45	6	35	25	10
LK.FD.D6-45-66	6	35	25	10

Voor hogedrukleiding 840 bar Ø 6,35 x 11,3

Artikelnummer / Référence	da	h	L	sw
LK.FD.6,3X11,3-6-45	6	35	25	12
LK.FD.6,3X11,3-8-45	6	35	25	12

INSTEKHULS DOUILLE D'INSERTION

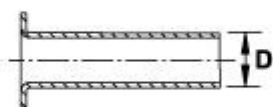

Artikelnummer / Référence	D	Voor leiding Ø Pour tuyau Ø
LPA.E.04-2	2	4 X 1
LPA.E.04-2,3	2,3	4 X 0,85
LPA.E.04-2,5	2,5	4 X 0,75
LPA.E.05-6-3	3	6 X 1,5
LPA.E.05-6-4	4	6 X 1
LPA.E.08-4	4	8 X 2
LPA.E.08-5	5	8 X 1,5
LPA.E.08-10-6	6	8 X 1
LPA.E.10-7	7	10 X 1,5
LPA.E.10-7,5	7,5	10 X 1,25
LPA.E.10-8	8	10 X 1
LPA.E.12-8	8	12 X 2
LPA.E.12-9	9	12 X 1,5
LPA.E.12-15-10	10	12 X 1
LPA.E.15-12	12	15 X 1,5
LPA.E.15-16-12,5	12,5	15 X 1,25
LPA.E.18-14	14	18 X 2
LPA.E.18-20-16	16	18 X 1
LPA.E.22-18	18	22 X 2

STEEKKOPPELING MET INBUS RACCORDS INSTANTANÉS À TROUS HEXAGONALS

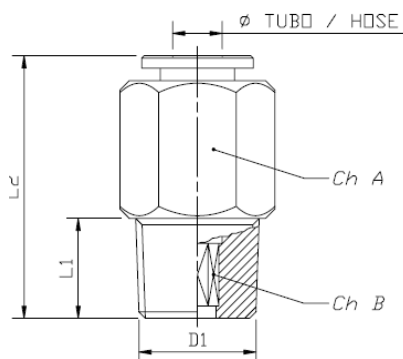

bedrijfsdruk: ca. 250 bar / pression de service: ca.250 bar

Artikelnummer / Référence	D	D1	L1	L2	Ch A	Ch B
CK.SK.GE.INB -04-0516	4	5/16" 24 fil 1"	8.0	22	10	3.0
CK.SK.GE.INB -04-R02	4	1/8" GAS	8.0	21	10	3.0
CK.SK.GE.INB -04-M06x0.75	4	M 6x0.75	6.0	23	10	2.5
CK.SK.GE.INB -04-M06x1	4	M 6x1	8.0	25	10	2.5
CK.SK.GE.INB -04-M08x1	4	M 8x1	8.0	22	10	3.0
CK.SK.GE.INB -04-M10x1	4	M 10x1	8.0	21	11	3.0
CK.SK.GE.INB -06-0516	6	5/16" 24 fil 1"	8.0	28	12	4.0
CK.SK.GE.INB -06-R02	6	1/8" GAS	8.0	26	12	4.0
CK.SK.GE.INB -06-R04	6	1/4" GAS	11.0	26	14	4.0
CK.SK.GE.INB -06-M06x1	6	M 6x1	8.0	28	12	2.5
CK.SK.GE.INB -06-M08x1	6	M 8x1	8.0	28	12	4.0
CK.SK.GE.INB -06-M10x1	6	M 10x1	8.0	24	12	4.0
CK.SK.GE.INB -06-M12x1	6	M 12x1	9.0	25	13	4.0

BANJO PUSH IN HAAKS DRAAIBAAR

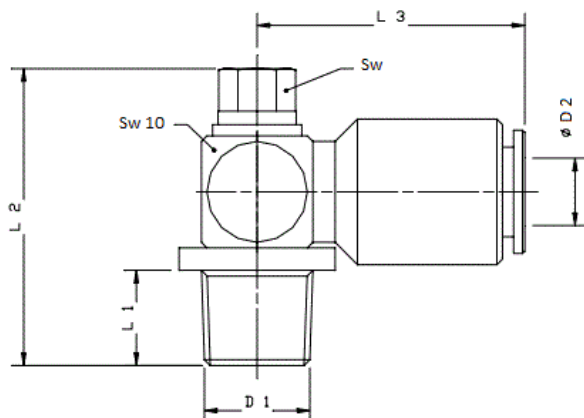

bedrijfsdruk: ca. 250 bar

Barstdruk: 900 bar

Medium: olie of vet

Dichting: NBR

Temperatuur: -20°C .. 120 °C

Artikelnummer	D2	D1	L1	L2	L3	Sw
ILC.SK.WE-04-R02	4	1/8" Bsp	7.5	25	22	6
ILC.SK.WE-04-M06x0.75	4	M 6x0.75	6.0	24	22	6
ILC.SK.WE-04-M06x1	4	M 6x1	8.0	26	22	6
ILC.SK.WE-04-M08x1	4	M 8x1	8.0	26	22	6
ILC.SK.WE-04-M10x1	4	M 10x1	8.0	26	22	6
ILC.SK.WE-06-R02	6	1/8" Bsp	7.5	25	24	6
ILC.SK.WE-06-M06x1	6	M 6x1	8.0	26	24	6
ILC.SK.WE-06-M08x1	6	M 8x1	8.0	26	24	6
ILC.SK.WE-06-M10x1	6	M 10x1	8.0	26	24	6
ILC.SK.WE-06-M12x1	6	M 12x1	9.0	26	24	6

ROTERENDE SCHROEFKOPPELING HAAKS (SWIVEL) RACCORDS ORIENTABLES

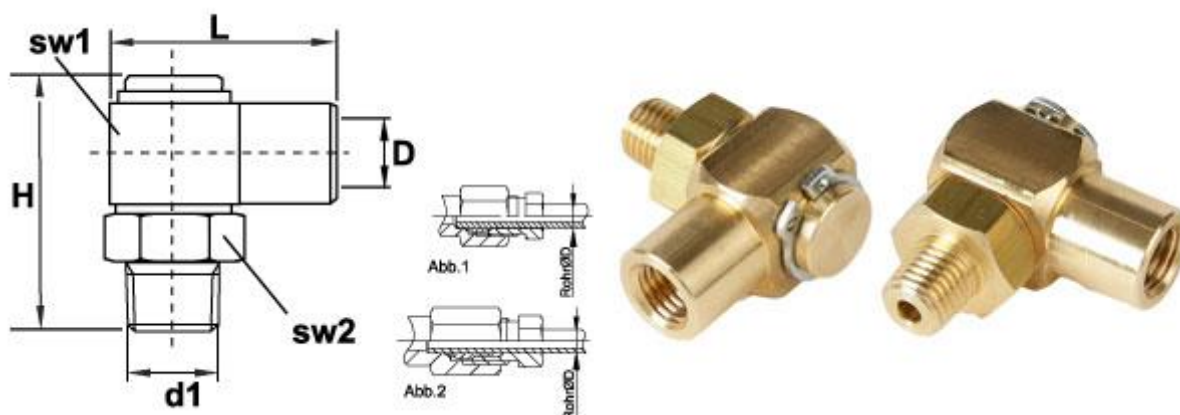

Artikelnummer / Référence	D	D1	sw1	sw2	H	L	tuyau Ø
CK.DA.04M06X1	M 8x1	M 6x1	15	14	30	26,5	4
CK.DA.04M08X1	M 8x1	M 8x1	15	14	30	26,5	4
CK.DA.04M08X1.25	M 8x1	M 8x1.25	15	14	30	26,5	4
CK.DA.04M10x1	M 8x1	M 10x1	15	14	30	26,5	4
CK.DA.04R02	M 8x1	R 1/8 BSP	15	14	30	26,5	4
CK.DA.06M06X1	M 10x1	M 6x1	15	14	30	29	6
CK.DA.06M08X1	M 10x1	M 8x1	15	14	30	29	6
CK.DA.06M10X1	M 10x1	M 10x1	15	14	30	29	6
CK.DA.06R02	M 10x1	R 1/8 BSP	15	14	30	29	6

FLEXIBELE BESCHERMBUIS CONDUIT FLEXIBLE



Artikelnummer / Référence	di	da	s	spoel/bobine
EL.FH.PA-NW6,7	6,7	10	1,6	50
EL.FH.PA-NW8,4	8,4	11,7	1,6	50
EL.FH.PA-NW10	10	12,9	1,5	50
EL.FH.PA-NW12	12	15,7	1,7	50

BESCHERMSPIRAAL PROTECTION À RESSORT

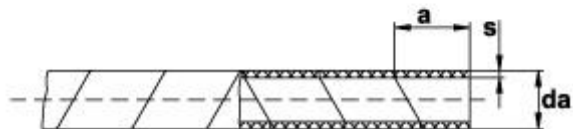

Artikelnummer / Référence	a	da	s	lengte / longueur
LB.BSS.6MM	10	6	1	25
LB.BSS.11,5MM	10	11,5	1,5	25

A. SNELKOPPELING MET TERUGLOOPAANSLUITING VROUWELIJK

A. ACCOUPLEMENT AVEC CONNECTION RETOUR

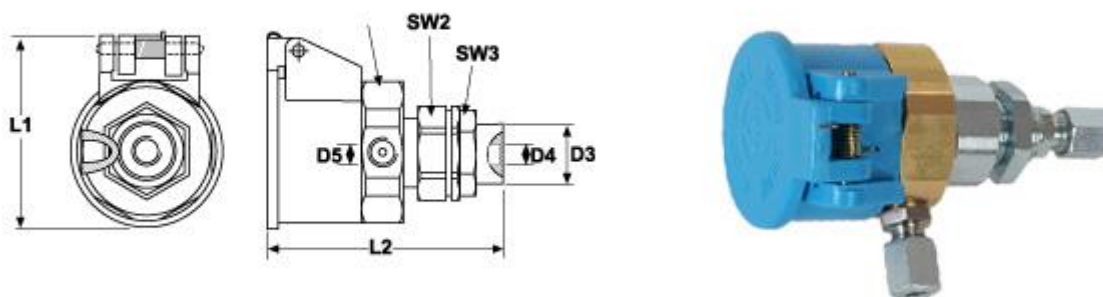

Koppeling met terugloopaansluiting voor vetsmering

Artikelnummer / Référence	L1	L2	SW1	SW2	SW3	D3	D4	D5
CK.SNK.TL-F-6	68	84	46	30	27	M 20 x 1,5	M10 x 1	M 10 x 1

Materiaal: kunststof, messing, staal

Deze koppeling maakt het mogelijk om, de met vet gevulde hogedrukleiding die de pomp met de verschillende smeerpunten verbindt, te onderbreken. Bij het ontkoppelen van de koppelingstekker (B) uit de koppeling (A) wordt het vet automatisch naar de terugloop van de pomp gestuurd.

B. KOPPELINGSSTEKKER VOOR KOPPELING A

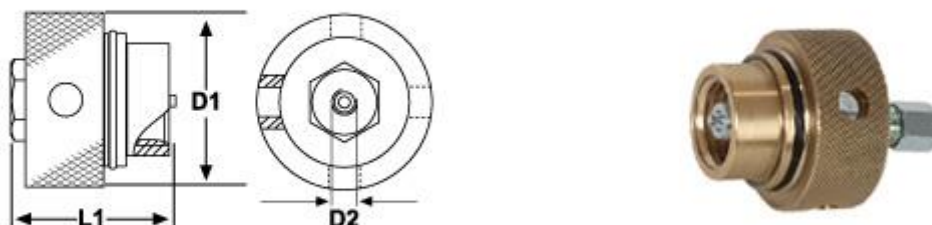

Artikelnummer / Référence	L1	D1	D2
CK.SNK.TL-M-6L	52	55	M 10 x 1

Materiaal: messing en staal

C. HOUDER VOOR KOPPELING A

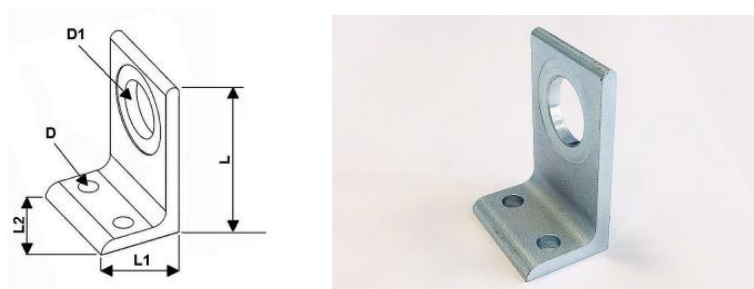

Artikelnummer / Référence	D	D1	L	L1	L2
CK.SNK.TL-H	6	21,5	60	30	40

ADAPTER

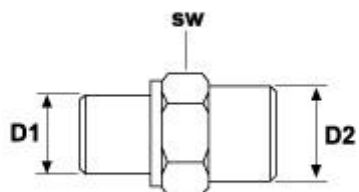

Art. Nr.	D1	D2	SW
FI.245.R04-R04ST	1/4 BSPP	1/4 BSPP	17
FI.245.M20-R04ST	1/4 BSPP	M 20 x 1,5	24
FI.245.M22-R04ST	1/4 BSPP	M 22 x 1,5	24

Material: steel, galvanized surface

ADAPTER

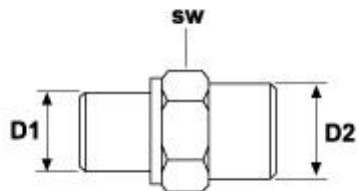

Art. Nr.	D1	D2	SW
FI.245.R04-R04ST	1/4 BSPP	1/4 BSPP	17
FI.245.M20-R04ST	1/4 BSPP	M 20 x 1,5	24
FI.245.M22-R04ST	1/4 BSPP	M 22 x 1,5	24

Materiaal: staal, oppervlak verzinkt

VERSTELBARE SCHROEFAANSLUITING MET AFDICHTING VOOR MANOMETER FERMETURE AJUSTABLE AVEC JOINT POUR MANOMETRES

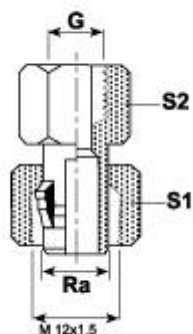

Art. Nr.	G	Ra	S1	S2
CK.MAV.06LR04	1/4 BSP	6 L	14	19

materiaal: staal, oppervlakte verzinkt

VERSTEVIGENDE SPIRAAL IN INOX SPIRALE DE PROTECTION ANTI-TORSION, INOX 1.4301/304

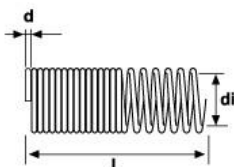

Art. Nr.	L mm	di mm	d
LB*BSS.10,6-200 inox	200	10,6	1,2

matériau: acier inoxydable, inox 1.4301 / 304

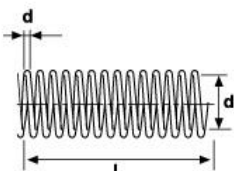

Art. Nr.	L mm	di mm	d
LB*BSS.10,6-2000 inox	2000	10,6	1,2
LB*BSS.10,6-5000 inox	5000	10,6	1,2

matériau: acier inoxydable, inox 1.4301 / 304

Hoge drukleiding 840 BAR

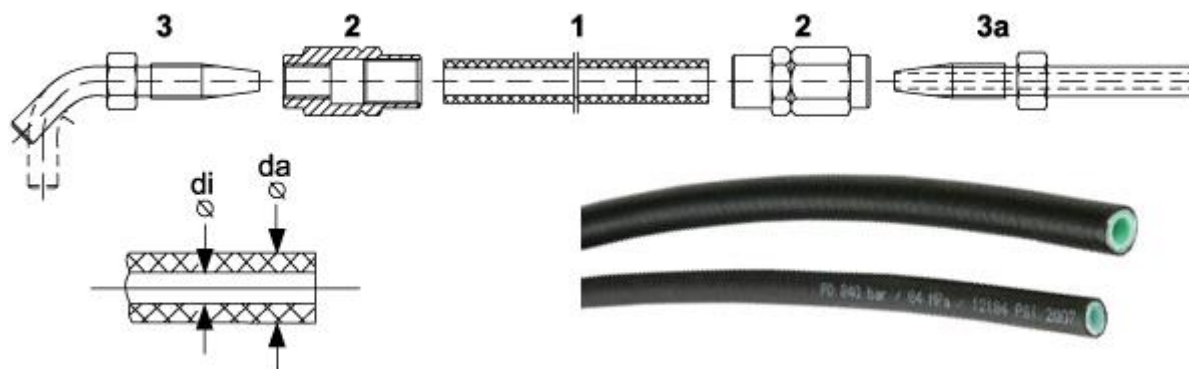

1	Hoge druk leiding 840 bar
2	schroefhuls
3	Pijpstuk (F-doorn) 45 ° of 90°
3A	Pijpstuk (F-doorn) recht

Technische fiche

di	da	referentie	Verpakking	divers
4,0	8,6	LPA.AF4.DN4	50 m	leeg
4,0	8,6	LPA.S.HD8,3-2,1	50 m	Gevuld met NLGI 2 vet
6,3	6,3	LPA.BF6,3.DN6	100 m	leeg
6,3	6,3	LPA.S.HD11,3-6,3	100 m	Gevuld met NLGI 2 vet
1/8 "	5/16 "		50 m	leeg

		LPA.AF4.DN4/ LPA.S.HD8,3-2,1		LPA.BF6,3.DN6/ LPA.S.HD11,3-6,3	
		Binnenbekleding	Buitenbekleding	Binnenbekleding	Buitenbekleding
Materiaal		Thermoplast. Polyamide 6	Thermoplast. Polyuretaan	Thermoplast. Polyamide 12	Thermoplast. Polyuretaan
Breuk	DIN EN ISO 527	> 30 N/mm ²	> 18 N/mm ²	> 38 N/mm ²	> 20 N/mm ²
Treksterkte	DIN EN ISO 527	> 50 %	> 380 %	> 250 %	> 320 %
Hardheid	DIN EN ISO 868	>D 60 +/-3	>D 88 +/-3	>D 61 +/-3	>A92 +/-3
Temperatuur- bereik	Van -30 °C t.e.m. 80 °C In geval van vet met additieven anti-corrosie "": max. 60°C				

HOEKSTUK 90° RACCORD COUDÉ 90°

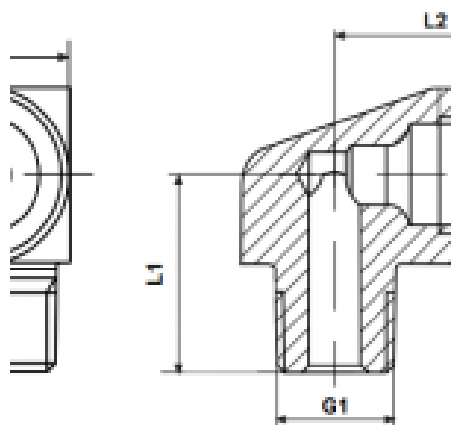

90° aansluitstuk met conische schroefdraad. Materiaal messing

Artikelnummer / Référence	G1	L1	L2	SW
CK.WE.V.4M06X1	M 6 x 1	13,5	13,6	12
CK.WE.V.4M08X1	M 8 x 1	13,5	13,6	12
CK.WE.V.4M10X1	M 10 x 1	13,5	13,6	12

KNELRING MONO MONOCÔNE

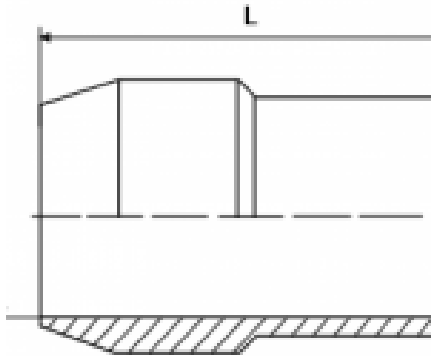

Artikelnummer / Référence	D	L
LK.OSV.ME-04-V	4	8
LK.OSV.ME-06-V	6	9,5
LK.OSV.ME-10-V	10	

BANJO PUSH IN HAAKS DRAAIBAAR MET TERUGSLAGKLEP RICHTING PUSH-IN

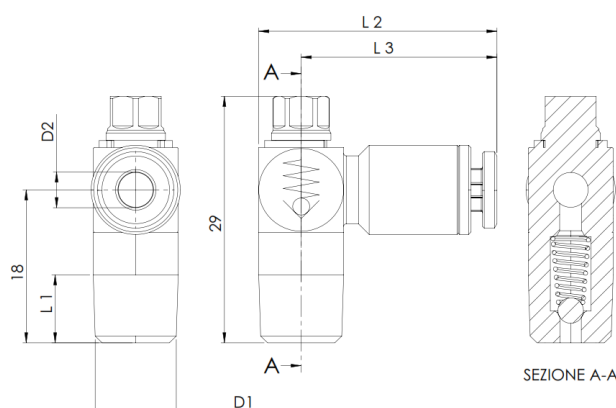
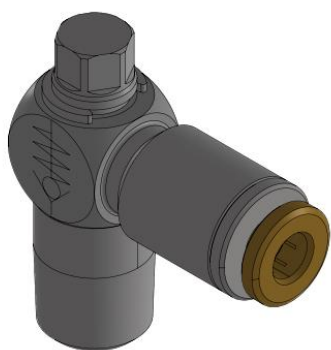

bedrijfsdruk: ca. 250 bar

Medium: olie of vet

Dichting: NBR

Temperatuur: -20°C .. 120 °C

Artikelnummer	D2	D1	L1	L2	L3	Sw
ILC.TSKU.WE04-M10x1	4	M 10x1	8.0	28.1	23.1	6
ILC.TSKU.WE06-R02	6	1/8" Bsp	7.5	30.3	25.3	6
ILC.TSKU.WE06-R04	6	1/4" Bsp	11	33	25.3	6
ILC.TSKU.WE06-M10x1	6	M 10x1	8.0	30.3	25.3	6

BANJO PUSH IN HAAKS DRAAIBAAR MET TERUGSLAGKLEP RICHTING SCHROEFDRAAD

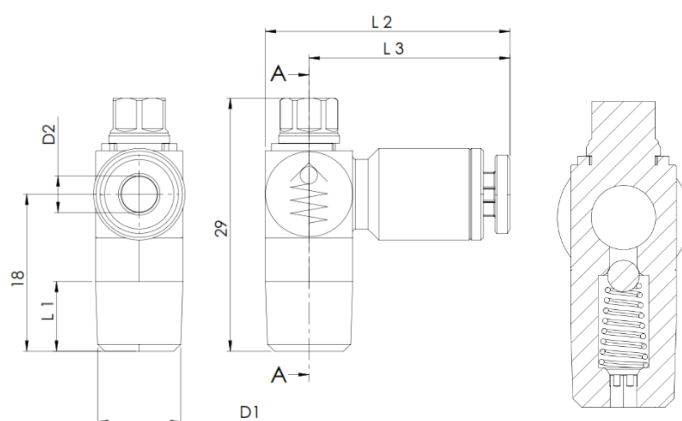
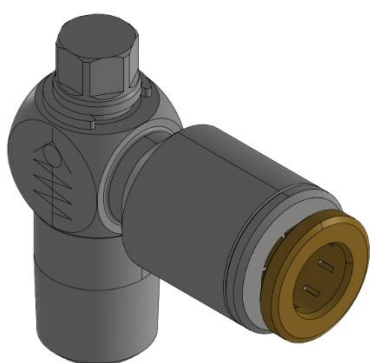

SEZIONE A-A

bedrijfsdruk: ca. 250 bar

Medium: olie of vet

Dichting: NBR

Temperatuur: -20°C .. 120 °C

Artikelnummer	D2	D1	L1	L2	L3	Sw
ILC.TSKI.WE04-M10x1	4	M 10x1	4.2	28.1	23.1	6
ILC.TSKI.WE06-R02	6	1/8" Bsp	7.5	30.3	25.3	6
ILC.TSKI.WE06-R04	6	1/4" Bsp	11	33	25.3	6
ILC.TSKI.WE06-M10x1	6	M 10x1	8.0	30.3	25.3	6

PUSH-IN RECHT MET TERUGSLAGKLEP RICHTING SCHROEFDRAAD

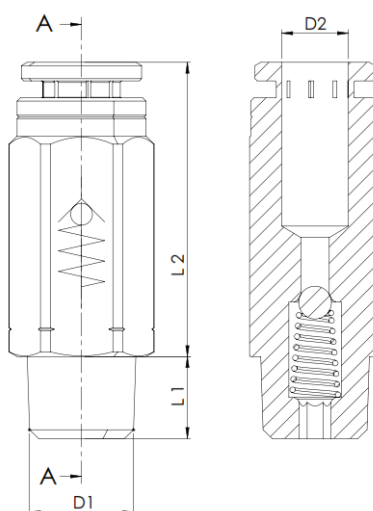
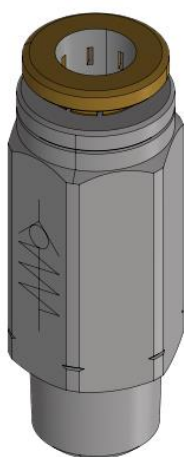

bedrijfsdruk: ca. 250 bar

Medium: olie of vet

Dichting: NBR

Temperatuur: -20°C .. 120 °C

Artikelnummer	D2	D1	L1	L2	SW
CK.TSKI.GE06-R02	6	1/8" Bsp	7.5	27	12
CK.TSKI.GE06-R04	6	1/4" Bsp	11	23.5	14
CK.TSKI.GE06-M10x1	6	M 10x1	8.0	26.5	12

PUSH-IN RECHT MET TERUGSLAGKLEP RICHTING PUSH-IN

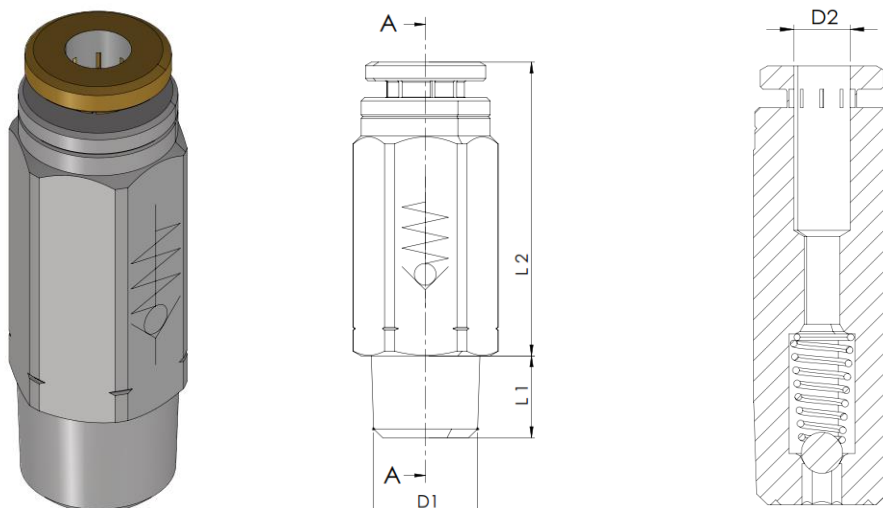

bedrijfsdruk: ca. 250 bar

Medium: olie of vet

Dichting: NBR

Temperatuur: -20°C .. 120 °C

Artikelnummer	D2	D1	L1	L2	SW
CK.TSKU.GE06-R02	6	1/8" Bsp	7.5	27	12
CK.TSKU.GE06-R04	6	1/4" Bsp	11	23.5	14
CK.TSKU.GE06-M10x1	6	M 10x1	8.0	26.5	12